

From **Brakes India**



# The **Most Trusted** Name In Safety Launches High Performance Clutches



FOR COMMERCIAL VEHICLES

# About

## REVIA CLUTCHES

REVIA Clutches are designed with advanced engineering to meet the rigorous demands of heavy-duty trucks, buses, and commercial vehicles. Built for strength, durability, and reliability, it ensures consistent power transmission even under extreme load and long-haul driving conditions.

Developed using premium friction materials and reinforced spring technology, REVIA clutches provides superior heat dissipation, wear resistance, and longer service life — reducing downtime and maintenance costs for fleet operators.

Keep your fleet moving with REVIA – **Your Journey, Our Promise.**



# Features

## REVIEW CLUTCHES

 Smooth Engagement  
& Disengagement

 Durability  
& Longevity

 High Torque  
Transmission Efficiency

 Excellent  
Thermal Resistance

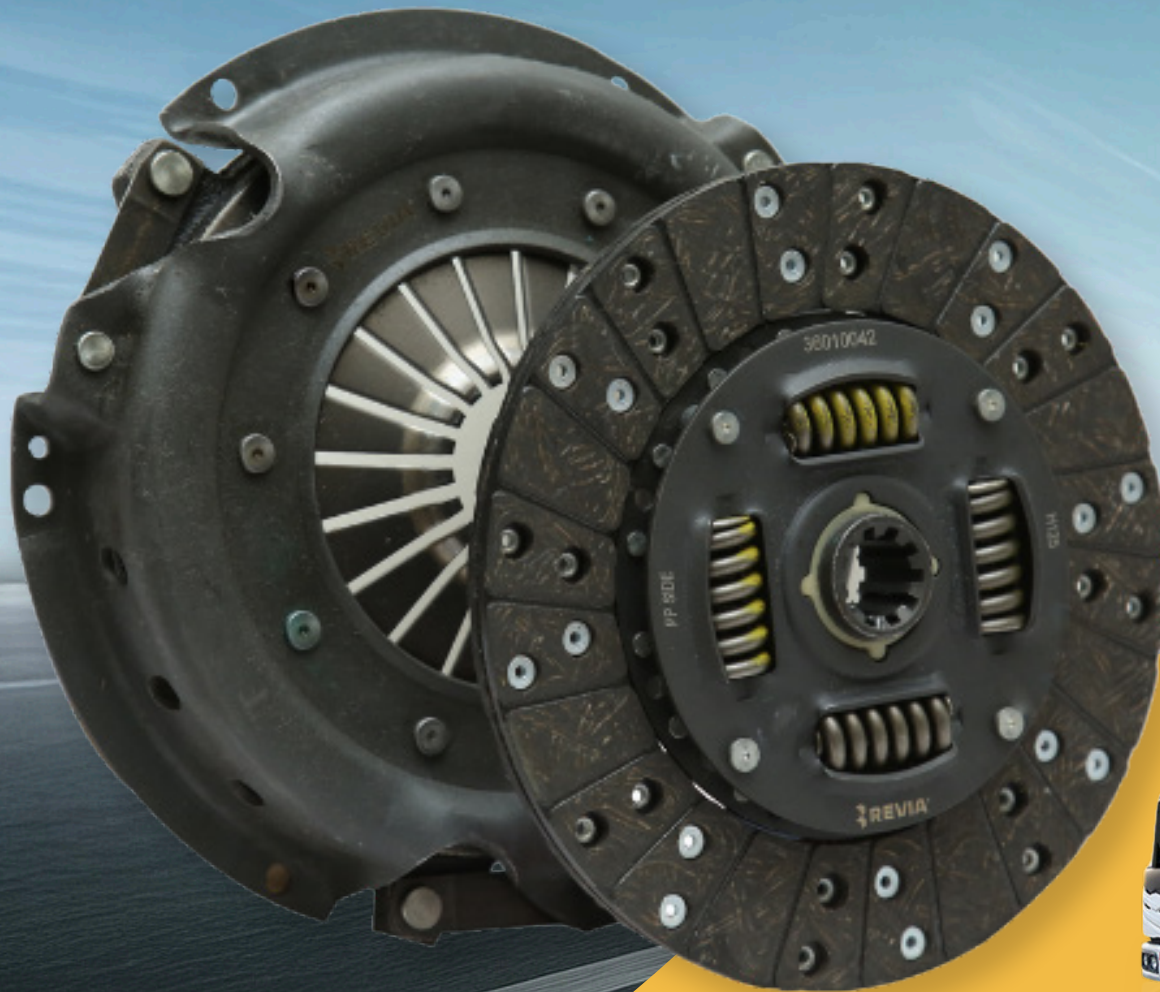

Revvia Clutches

# Exploded View of DIAPHRAGM TYPE COVER ASSEMBLY

Diaphragm-type clutch cover assemblies are widely used in modern commercial vehicles due to their compact design, consistent clamping force, and improved driver comfort. The diaphragm spring mechanism provides uniform pressure distribution across the friction surface, supporting smoother engagement and reliable power transmission under varying load and road conditions.

### Key Features:

Uniform clamping force through diaphragm spring design.  
Compact and lightweight for efficient vehicle integration.

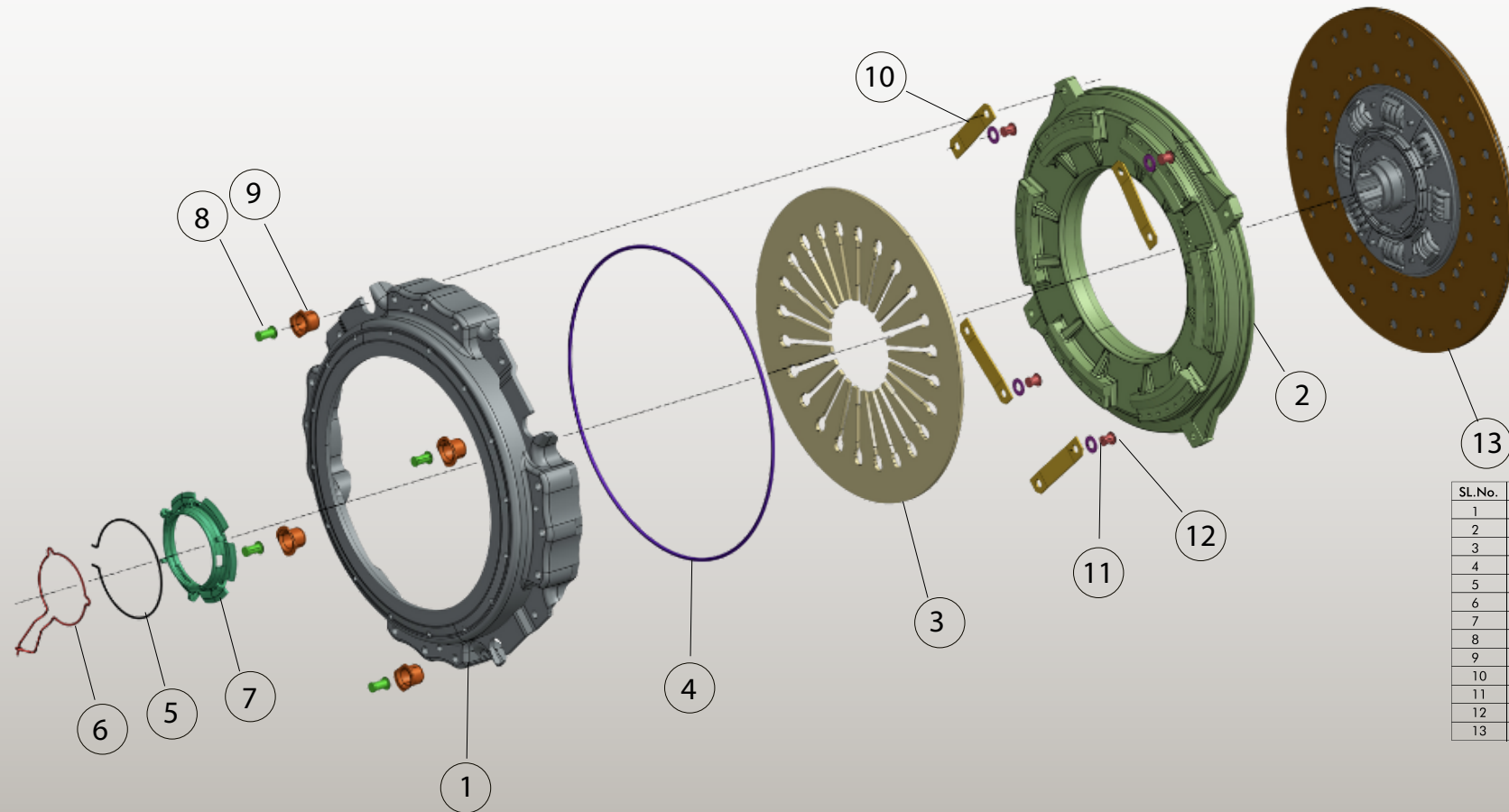

SL.No.	PART NAME
1	COVER
2	PRESSURE PLATE
3	DIAPHRAGM SPRING PLATE
4	CIRCULAR FULCRUM RING
5	WIRE CLIP
6	LOCATOR CLIP
7	COVER BRACKET
8	RIVET
9	RIVET HOLDING CUP
10	PLATE
11	WASHER
12	COVER RIVET
13	DISC ASSEMBLY (ORGANIC)

# Exploded View of COIL TYPE COVER ASSEMBLY

Coil type clutch cover assemblies are traditionally used in commercial vehicles known for their high torque handling capability and robust mechanical operation. This design incorporates multiple coil springs and release levers to maintain clamping pressure, ensuring reliable engagement even under demanding load and transmission conditions

### Key Features:

Multiple coil springs for stable and progressively applied clamping force.  
Sturdy lever mechanism ensuring reliable engagement and disengagement.

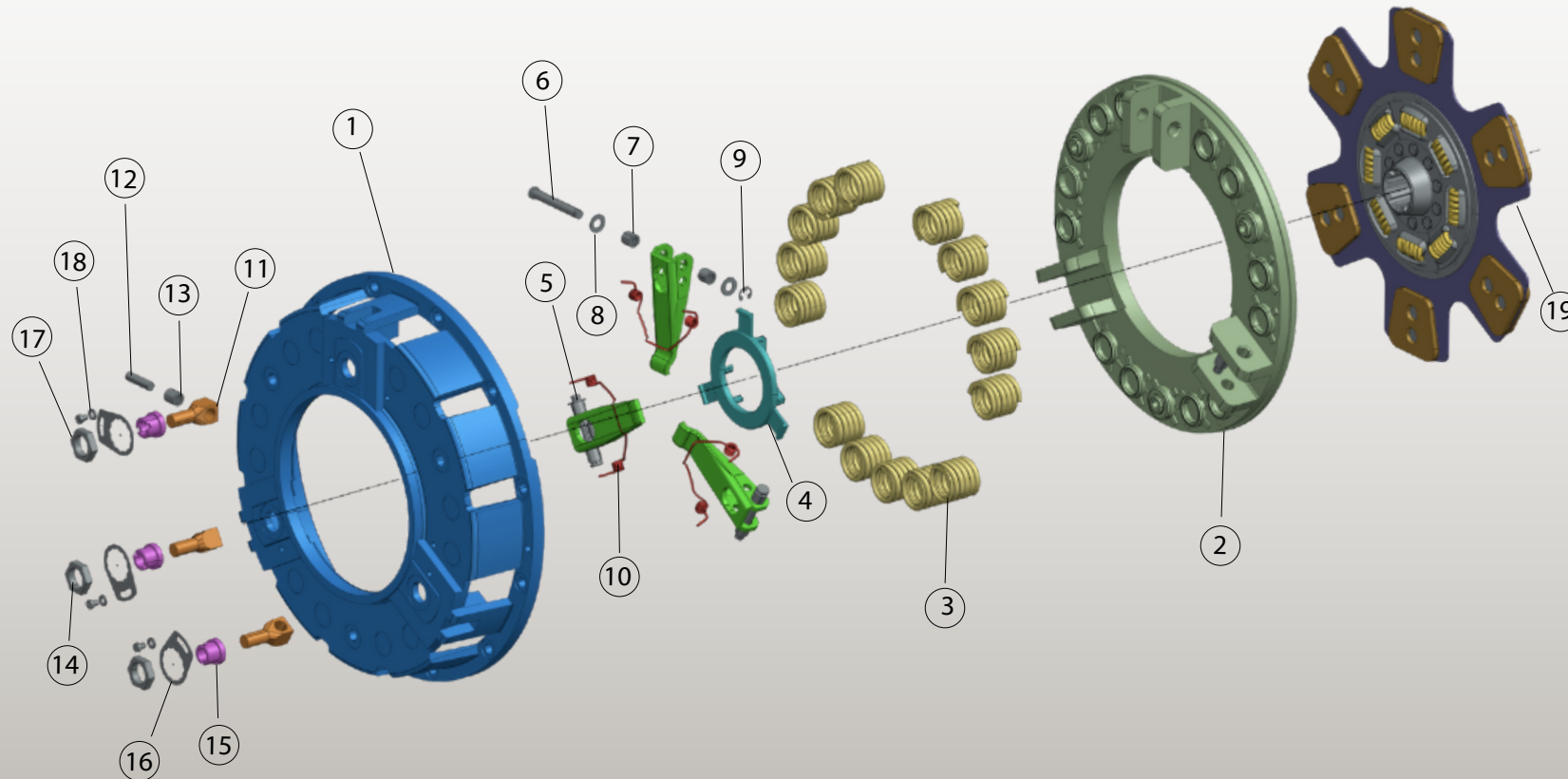

SL.No.	PART NAME
1	COVER
2	PRESSURE PLATE
3	SPRING
4	RETAINER PLATE
5	LEVER
6	LONG PIN
7	BEARING CAGE
8	WASHER
9	CIRCLIP
10	AR SPRING
11	YOKE
12	SUPPORT PIN
13	BEARING CAGE
14	NUT
15	ADJUSTER NUT
16	LOCK WASHER
17	SCREW
18	LOCK WASHER
19	DISC ASSEMBLY (CERAMIC)

# Revia Clutch Applications

S.No	Make	Application	Size	Combo		Part Number
				Part Number	Cross Reference	
1	AL	BS3 HAULAGE -ECOMET 1012/1212/1112/1214/912, 1612	13"(330)	36010048	-	36010050
2	AL/TATA/ EICHER	BOSS 912 LE, BOSS 1112 LE, BOSS 1212 LE, ECOMET 10T SMART, ECOMET 10T STRONG, ECOMET 12T SMART, ECOMET 12T STRONG, STAG SCHOOL BUS, LYNX SCHOOL BUS	13"(330)	36010047	P5106139	36010034
3	AL	CHEETAH / COMET / TUSKER TIPPER	14"(353)	-	-	36010057
4	AL	3518 / 3118 / 2518 / 4019 / 3718 / U-2518 (EXCEPT 9 SPEED)	15"(380)	36010041	P5104486	36010003
5	AL	TIPPER BSIV U 2518, TIPPER BSIII 2523/2518/2523/3123, TRACTOR 4023	15"(380)	36010040	P5104485	36010058
6	TATA	407 TURBO/ 207 DI	9"(240)	36010042	-	36010016
7	TATA	709 TURBO / LPT809,Y1 FAMILY (6.5T), LPT909,LP909CNG, SFC 909 , LP410,LPT/SFC 407BS3, 407CNG, LPT 610,SFC 709 BSII, LPT709 CNG BSIII, LPT709BSII	11"(280)	36010043	-	36010018
8	AL/TATA/ EICHER	TATA : 1210 SE/1312/1510/1612/1613/2212/1109, EICHER : 1095 / 2075 (ALL 5 SPEED), ASHOK LEYLAND : VECO 709/ 909/ CARGO MODEL / STAG /LYNX BUS / ECOMET	12"(310)	-	-	36010020
9	TATA	1210	12"(310)	-	-	36010055
10	TATA/ EICHER	TATA :1613 TURBO / 1510 TC /TIPPER MODELS BS-III (3L), EICHER :20.16 / 3015 JUMBO (ALL 7 SPEED)	13"(330)	-	-	36010023
11	TATA	1613 TURBO / 1510 TC / TIPPER MODELS BS-III (4L)	13"(330)	-	-	36010061
12	TATA/ EICHER	TATA : 2515 / 2516 / 3015 / 3516 / 4018 BSII (GB60)(3L PULL TYPE), EICHER: 30.25/33.25/35.31 (GB60)(3L PULL TYPE)	14"(352)	36010044	275225000105	36010028
13	TATA	LPK 2516/LPT 2521 / LPT3718 / LPT2518 / LPK2518/LPK1618 / LPT3518 / SIGNA 4923 / TATA LPO1618 (3L)(GB75)	15"(380)	36010045	885425013118	36010030
14	TATA	PRIMA 4028 / 4023 / 3128 / 2528 / 3138	17"(430)	-	-	36010032
15	DICV	1923C /2823C / 3123 - HDT	15.5"(395)	-	-	36010004
16	DICV	2823C / 2828CH / 3528C / 3528CM / 4828R / 4828RT	17"(430)	-	-	36010010
17	MAN	MAN- TRUCK	17"(430)	-	-	36010012
18	MTBL	NAVISTAR-CARGO 25T/31T/37T/41.2T/ 43T/ 43T-9S-1/35T-TR/ 40T-TR/ 40T-TR-9S-1/ 49T-TR/ 49T-TR-BOGIE TIP TRAILER - BS IV	17"(430)	-	-	36010014

Cover Assembly			Clutch Plate								
Cross Reference	Type	No. of Lever	Part Number	Cross Reference	Type	Grade	No. of Springs	No. of Pads	Spline Size (inch)	No. of Teeth	Thickness in (mm)
B1308103	COIL	4	36010049	B1308106	ORGANIC	VALEO F510 UL	8	-	1.4"	10	10.8
B1M03401	DIAPHRAGM	-	36010035	FAT02000	ORGANIC	VALEO F510 UL	4	-	1.4"	10	10.8
B1301501	COIL	4	36010001	B1304201	CERAMIC	MIBA - MD592	8	6	1.5"	10	14
-	-	-	36010002	B1304704	ORGANIC	VALEO F410	8	-	1.5"	10	14
B1M04301	COIL	3	36010006	B1M05001	CERAMIC	MIBA - MD592	8	6	1.5"	10	12
B1M04301	COIL	3	36010007	B1M04302	CERAMIC	MIBA - MD592	8	6	1.75"	10	12
-	-	-	36010005	B1304301	CERAMIC	MIBA - MD592	8	6	1.5"	10	14
-	-	-	36010008	B1306301	CERAMIC	MIBA - MD592	8	6	1.75"	10	14
265125400114	DIAPHRAGM	-	36010017	265125200132	ORGANIC	VALEO F510UL	4	-	1.1"	10	9.2
264025400102	DIAPHRAGM	-	36010019	272425200216	ORGANIC	VALEO F510UL	8	-	1.4"	10	10.6
272425400160	DIAPHRAGM	-	36010021	272425200165	ORGANIC	COMPO - RWCGDY/ KEMA- KM165	7	-	1.4"	10	10.8
257325400117	COIL	4	-	-	-	-	-	-	-	-	-
272425400138 /ID315672	COIL	3	36010052	272425200163/ ID303746	CERAMIC	MIBA - MD592	7	6	1.4"	10	11.2
276325400121	COIL	4	36010024	272425200151	ORGANIC	VALEO F510UL	7	-	1.4"	10	10.8
275225400105 /ID206097	COIL WITH CRB	3	36010027	275225200106	CERAMIC	MIBA - MD592	8	6	1.75"	10	11.7
-	COIL WITHOUT CRB	3	36010029	581225200101	ORGANIC	VALEO F510UL	8	-	1.75"	10	11.7
272425400215	COIL	3	36010031	272425200134	ORGANIC	VALEO F510UL	8	-	1.75"	18	12
580525400118	DIAPHRAGM	-	36010033	580525200108	ORGANIC	VALEO F510UL	8	-	2"	10	10.3
A4002500004	DIAPHRAGM	-	36010009	A4002501304	ORGANIC	VALEO F510UL	6	-	2"	18	10
A4002500104	DIAPHRAGM	-	36010011	A4002500103	ORGANIC	VALEO F510UL	6	-	2"	18	10.3
64303050006	DIAPHRAGM	-	36010013	64303010006	ORGANIC	VALEO F510UL	6	-	1.75"	10	10.3
6801AAP00012N	DIAPHRAGM	-	36010015	6801BAU00021N	ORGANIC	VALEO F510UL	6	-	1.75"	10	10.8

S.No	Repair Kits	Size in Dia	Part No	Suitable Cover Assembly - Part No	Cross Reference	Make	Applications	Item Description	Qty
1	RELEASE BEARING KIT	352/14"	36610022	36010028 / 36010060	NA	TATA	2515 / 2516 / 3015 / 3516 / 4018 BSII (GB60)(3L PULL TYPE), Eicher: 30.25/33.25/35.31 (GB60)(3L PULL TYPE)	RELEASE BEARING	1
2	MAJOR KIT	310/12"	36610018	36010055	257325400602	TATA	1210	LEVER WITH ROLLER SUPPORT ANTIRATTLE SPRING LONG PIN SMALL PIN LOCK WASHER ADJUSTING NUT SPRING WASHER GUIDE PLATE SPLIT PIN SCREW SPRING	4 4 4 4 4 4 4 4 4 4 4 12
3	MINOR KIT	310/12"	36610019	36010055	257325400603	TATA	1210	LEVER WITH ROLLER SUPPORT ANTIRATTLE SPRING LONG PIN SMALL PIN LOCK WASHER ADJUSTING NUT SPRING WASHER GUIDE PLATE SPLIT PIN SCREW	4 4 4 4 4 4 4 4 4 4
4	SPRING KIT	310/12"	36610020	36010055	NA	TATA	1210	SPRING	12
5	PRESURE PLATE KIT	310/12"	36610021	36010055	NA	TATA	1210	PRESSURE PLATE	1

S.No	Repair Kits	Size in Dia	Part No	Suitable Cover Assembly - Part No	Cross Reference	Make	Applications	Item Description	Qty
1	MAJOR KIT	353/14"	36610013	36010057	NA	ASHOK LEYLAND	CHEETAH / COMET / TUSKER TIPPER	RELEASE LEVER THRUST PAD ECCENTRIC PIN BUSH ANTIRATTLE SPRING BOLT SPRING	4 4 4 4 4 4 12
2	MINOR KIT	353/14"	36610014	36010057	NA	ASHOK LEYLAND	CHEETAH / COMET / TUSKER TIPPER	RELEASE LEVER THRUST PAD ECCENTRIC PIN BUSH ANTIRATTLE SPRING BOLT	4 4 4 4 4 4
3	SPRING KIT	353/14"	36610015	36010057	P0957351	ASHOK LEYLAND	CHEETAH / COMET / TUSKER TIPPER	SPRING	12
4	PRESURE PLATE KIT	353/14"	36610023	36010057	F3032422	ASHOK LEYLAND	CHEETAH / COMET / TUSKER TIPPER	PRESSURE PLATE	1
5	MAJOR KIT	380/15"	36610017	36010003	P5105551	ASHOK LEYLAND	3518 / 3118 / 2518 / 4019 / 3718 / U-2518 (EXCEPT 9 SPEED)	LEVER LEVER SUPPORT ADJUSTING NUT HEX .NUT ANTIRATTLE SPRING RELEASE PIN SUPPORT PIN PLAIN WASHER EXTERNAL CIRCLIP INTERNAL TOOTH LOCK WASHER ROLLER BEARING (LEVER SUPPORT)	3 3 3 3 3 3 6 3 3 3 3
6	MINOR KIT	380/15"	36610016	36010003	PD600557	ASHOK LEYLAND	3518 / 3118 / 2518 / 4019 / 3718 / U-2518 (EXCEPT 9 SPEED)	LEVER LEVER SUPPORT SUPPORT PIN INTERNAL TOOTH LOCK WASHER	3 3 3 3
7	SPRING KIT	380/15"	36610012	36010003	P5105552	ASHOK LEYLAND	3518 / 3118 / 2518 / 4019 / 3718 / U-2518 (EXCEPT 9 SPEED)	SPRING	15
8	PRESURE PLATE KIT	380/15"	36610010	36010003	P7G00017	ASHOK LEYLAND	3518 / 3118 / 2518 / 4019 / 3718 / U-2518 (EXCEPT 9 SPEED)	PRESSURE PLATE	1

# Revia Clutch Notes



A series of horizontal dashed lines for taking notes, arranged in two columns. The lines are evenly spaced and extend across the width of the page, providing a structured area for writing.

# Revia Clutch Notes

A large area for taking notes, consisting of two columns of horizontal dashed lines. The lines are light blue and spaced evenly across the page, providing a guide for writing.

# Brakes India

Brakes India established in 1962, is part of the \$2.5 bn TVS Santhanam family group, with lineage from the erstwhileTVS group. Brakes India is headquartered in Chennai with 15 manufacturing plants across the country, supplying safety components to local and multinational OEM customers across the passenger cars, light commercial vehicles, heavy commercial vehicles, tractors and off-highway segments. Brakes India is the market leader in the aftermarket with diverse product groups – Friction, Braking and Fluids. Fluids cover wide range of products including Brake Fluids, Coolants, Steering fluid, and Engine oil.

For Consumer Feedback Contact:  
Consumer Care Officer, Marketing Division, Brakes India Private Limited (Part Of TSF Group),  
M.T.H Road, Padi, Chennai - 600 050, Tamil Nadu.

 044 - 3927 6705

 [bi-marketing@brakesindia.co.in](mailto:bi-marketing@brakesindia.co.in)

 [www.brakesindia.com](http://www.brakesindia.com)